

ODC75 - Casement
1:10

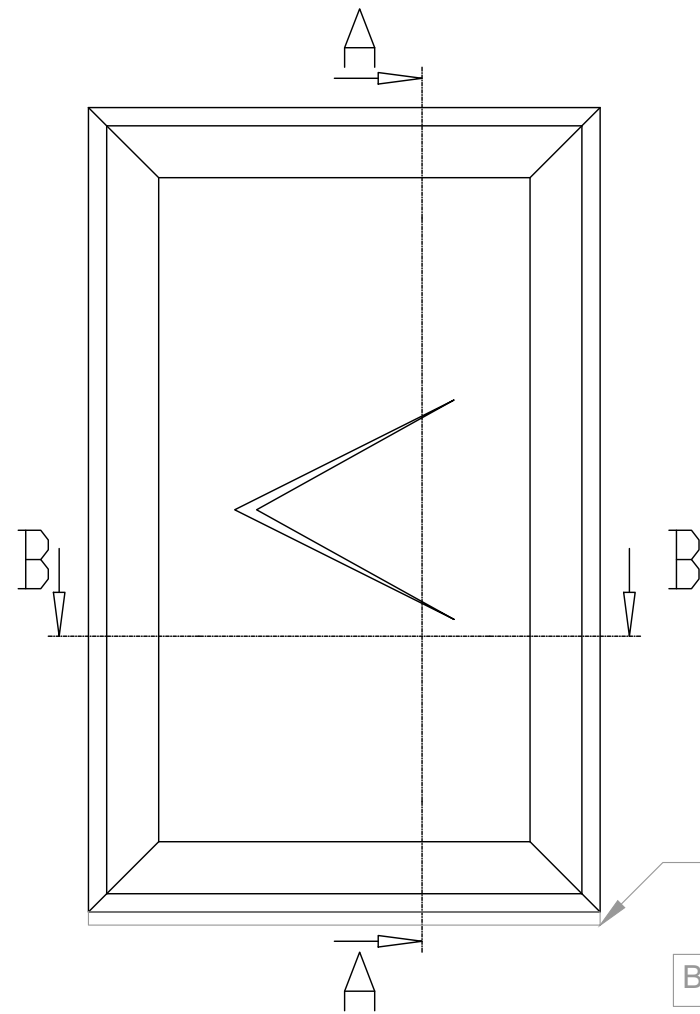

- Cill Options:**
 100mm
 135mm
 155mm
 190mm
 250mm

Bespoke cill pressings available

Section - AA
1:4

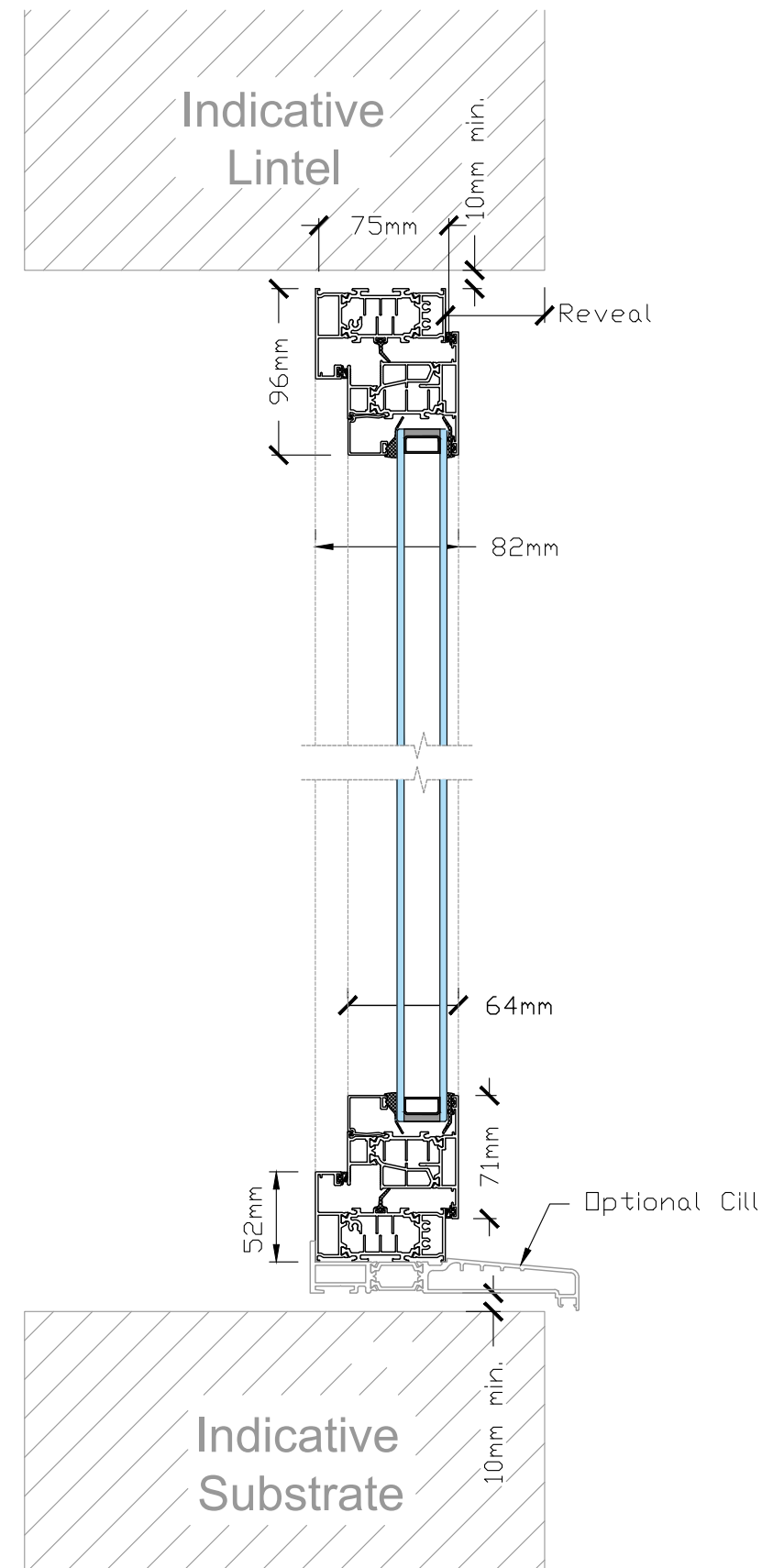

Section - BB
1:4

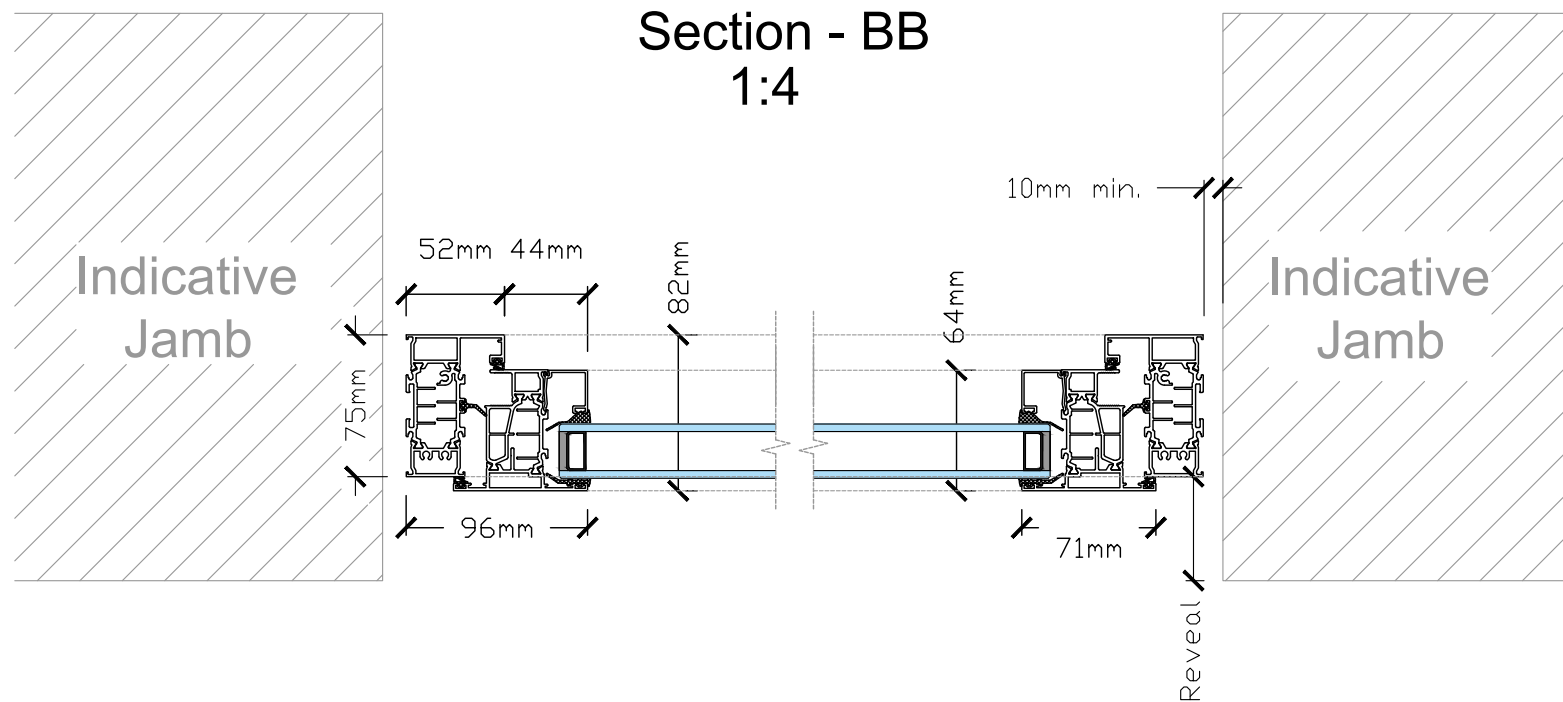

ODC75 SI

ODC Standard Products
© All Rights Reserved

Drawing:
ODC75si - Casement

Date: 27/01/21

Scale: 1:10 / 1:4 @ A3

Drawing No:
ODC-SP-75SI-CAS-C



ODC Door Glass Systems Ltd
www.odcglass.co.uk